

NOTE : POSTS MAY STOP 500 mm MAX. BELOW TOP OF GLASS.

RUBBER GASKETS AS REQUIRED.

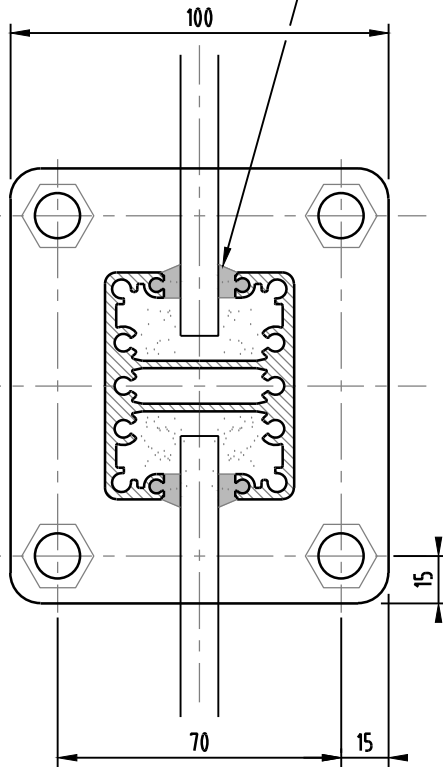

APE 'BERP' BASEPLATE
(SCALE 1:2)

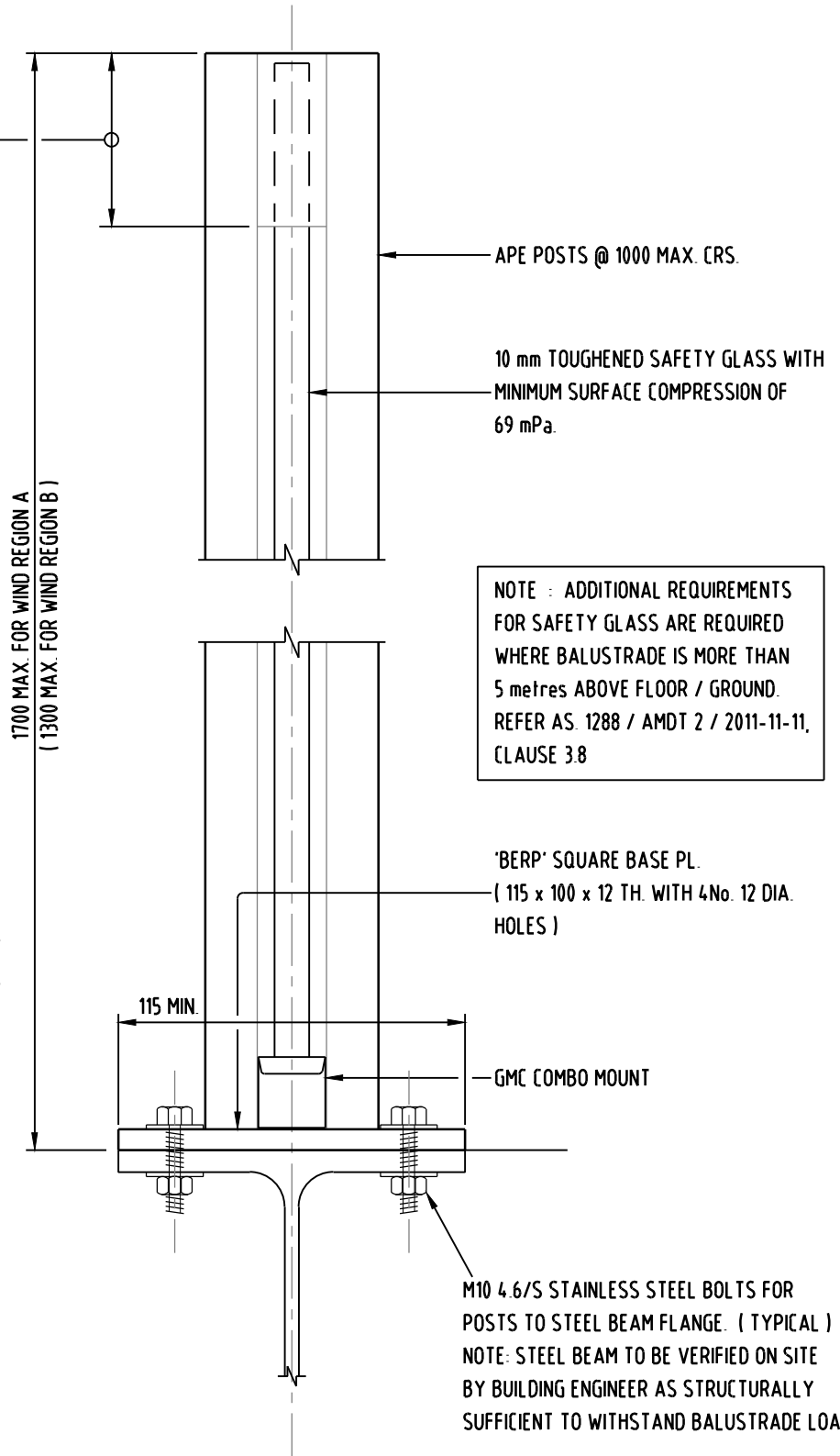

NOTE : ADDITIONAL REQUIREMENTS FOR SAFETY GLASS ARE REQUIRED WHERE BALUSTRADE IS MORE THAN 5 metres ABOVE FLOOR / GROUND. REFER AS. 1288 / AMDT 2 / 2011-11-11, CLAUSE 3.8

'BERP' SQUARE BASE PL.
(115 x 100 x 12 TH. WITH 4No. 12 DIA. HOLES)

M10 4.6/S STAINLESS STEEL BOLTS FOR POSTS TO STEEL BEAM FLANGE. (TYPICAL)
NOTE: STEEL BEAM TO BE VERIFIED ON SITE BY BUILDING ENGINEER AS STRUCTURALLY SUFFICIENT TO WITHSTAND BALUSTRADE LOADS

APE (SCALE 1:2)

DESIGN HORIZONTAL LIVE LOAD = 0.75 kN/m

APPLICABLE FOR WIND REGIONS A & B TO AS.1170 , TERRAIN CATEGORY 3

REGION A MAXIMUM BUILDING HEIGHT 10 m

REGION B MAXIMUM BUILDING HEIGHT 8 m

B	REFERENCE FOR GLAZING ABOVE 5m AMENDED	24.11.2014
A	ISSUED FOR CONSTRUCTION	9.01.2014
REV	COMMENTS	DATE

AXIOM GROUP P.O. BOX 94 , WERRIBEE. VIC. 3030 PH. 1300 652 336 EMAIL. sales@axiomgroup.com.au FAX. 1300 611 789 WEB. axiomgroup.com.au			
DESIGNED	IKF	DATE	JAN '14
DRAWN	AB	SCALE	1:2
REF No		ROLL No.	

CLIVE STEELE PARTNERS PTY LTD
CONSULTING ENGINEERS - STRUCTURAL & CIVIL



BUILDING 6
62/195 WELLINGTON ROAD
CLAYTON, VICTORIA
AUSTRALIA. 3168
Telephone (03) 9545 0223
Facsimile (03) 9545 3022
Email csp@clivesteele.com.au
A.C.N. 005 363 735 A.B.N. 92 627 427 761

VECTRO PRIVACY SCREENS. APE SEMI - FRAMELESS BALUSTRADE	
STEEL MOUNT	
DRG. No.	16996 - S - S04
	REV. B